

ASSOCIATED SURVEYORS OF SUMMERVILLE
P.O. BOX 6, SUMMERVILLE, S.C. 29484
843-873-1061

CHARLES R. & HEATHER E. SWICORD
TMS NO. 207-00-02-091

00026979
PLAT CABINET R, PAGE 48-Q
Filed and Recorded
Oct 08, 2013 11:04A
Cynthia B. Forte
Register of Deeds Berkeley Co. SC

LOCATION MAP
N.T.S.

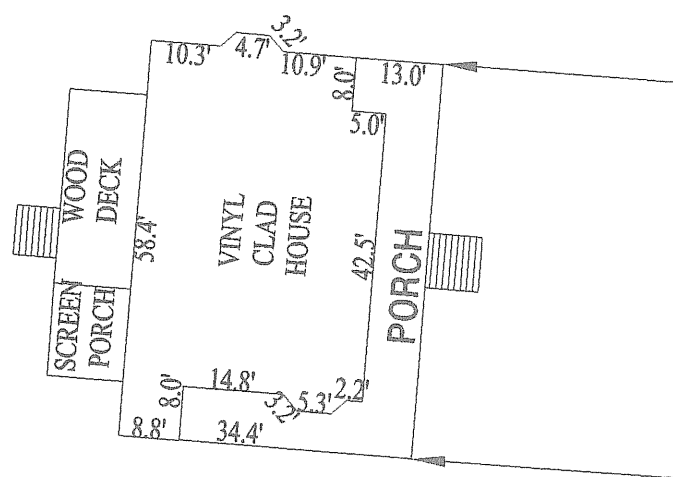
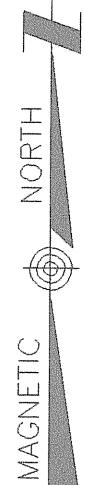

INSERT A

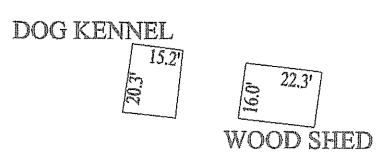

INSERT B

SANDRA D & STEPHEN T DAVIES
TMS: 207-00-02-093
EXISTING 10.45 ACRES
LESS 0.34 ACRES
TOTAL 10.11 ACRES

JUDITH M PASCULLIS
TMS: 207-00-02-051
EXISTING 32.86 ACRES
ADD 0.34 ACRES
TOTAL 33.20 ACRES

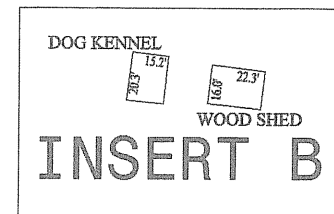
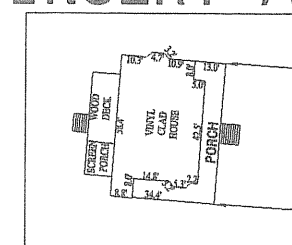

INSERT B

ELEANOR GREEN
TMS NO. 207-00-02-053

N 75°30'11"E 635.33'
NATHANIEL RD
66' R/W
S-8-1208

GRAPHIC SCALE - FEET
80 0 80 160 240
SCALE: 1"=80'

Curve	Radius	Tangent	Length	Delta	Chord	Chord Bear.
C1	239.40'	38.25'	75.86'	18°09'24"	75.55'	N 84°32'43" E
C2	3852.72'	117.34'	234.60'	3°29'20"	234.56'	N 05°23'49" E

Course	Bearing	Distance
L1	S 86°19'45" E	30.74'
L2	N 48°52'15" E	35.40'
L3	S 75°15'16" W	66.00'
L4	N 07°11'45" E	146.58'
L5	N 08°04'49" E	46.63'
L6	N 08°04'27" E	124.90'
L7	S 75°16'28" W	46.11'

SUBDIVISION SURVEY OF TMS: 207-00-02-093,
TRACT "A" 0.34 ACRES, OWNED BY SANDRA
D. AND STEPHEN T. DAVIES,
BEING CONVEYED TO
JUDITH M. PASCULLIS, ET. AL.,
AND IS TO AC RUE TO AND BECOME PART OF
TMS: 207-00-02-051, LANDS OWNED BY
JUDITH M PASCULLIS, ET. AL.

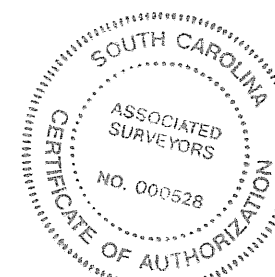

NEW HOPE AREA
BERKELEY COUNTY
SOUTH CAROLINA

AUGUST 28, 2013
JOB NO. 2013-106

I, JOHN DAVID BASS, HEREBY STATE TO THE BEST OF MY KNOWLEDGE, INFORMATION, AND BELIEF, THAT THE SURVEY SHOWN HEREON WAS MADE IN ACCORDANCE WITH THE REQUIREMENTS OF THE MINIMUM STANDARDS MANUAL FOR THE PRACTICE OF LAND SURVEYING IN SOUTH CAROLINA, AND MEETS OR EXCEEDS THE REQUIREMENTS FOR A CLASS "A" SURVEY AS SPECIFIED THEREIN. THERE ARE NO VISIBLE, TO THE SURVEYOR WHEN ON SITE, ENCROACHMENTS OR PROJECTIONS OTHER THAN THOSE NOTED ABOVE.

JOHN DAVID BASS, PLS.
S.C. REGISTRATION NO. 13388

FILE: DAVES WASHINGTON ROAD

Berkeley County Planning & Zoning
EXEMPT
recombination
(REASON)
10/7/13 DATE

AGENCY BLOCK

REFERENCE
1) PLAT BY HAGER E METTS, DATED APRIL 4, 1995, RECORDED IN PLAT BOOK F, PAGE 289
2) SCDOT FILE NO. 8.671, PROJECT NO. C-671, ROAD NO. S-158, SHEET 4 OF 19
3) PLAT BOOK L PAGE 109
NOTES
1) TMS NO. 207-00-02-093
2) ZONED FLEX-1
3) THIS PROPERTY IS LOCATED IN FLOOD ZONE X, AS PER FIRM PANEL NO. 45015C0560D, DATED OCTOBER 16, 2003
4) THIS PROPERTY WAS SURVEYED BY REFERENCE PLATS AND FIELD INFORMATION. NO TITLE SEARCH WAS PERFORMED BY ME NOR THIS COMPANY AS TO THE CLEAR TITLE TO THE PROPERTY.
5) THIS PROPERTY MAY BE SUBJECT TO OTHER UTILITY EASEMENTS, SUCH AS STORM SEWER, SANITARY SEWER, ELECTRIC, AND/OR TELEPHONE, THAT WERE NOT FOUND BY THE REFERENCE DEEDS OR PLATS NOTED HEREON. THIS PLAT DOES NOT DEFINE OR ADDRESS ANY SUBTERRANEAN CONDITIONS OF ANY OF THESE EASEMENTS, UNLESS NOTED SPECIFICALLY HEREON.
6) IF THE SIGNATURE UPON THIS PAPER IS NOT IN RED INK ALONG WITH A RAISED EMBOSSED SEAL THIS DOCUMENT IS NOT AN ORIGINAL SURVEY. VIEWER MAY BE WAIVED OF ITEMS THAT MAYBE ADDED AND OR CHANGED FROM THE ORIGINAL DRAWING.
COPYRIGHT 2013
BY ASSOCIATED SURVEYORS OF SUMMERVILLE