

NOTES: (1): THIS IS TO CERTIFY THAT I HAVE CONSULTED THE FEDERAL INSURANCE ADMINISTRATION FLOOD HAZARD BOUNDARY MAP, AND FIND THE SURVEY DESCRIBED IS NOT LOCATED IN A SPECIAL FLOOD HAZARD AREA.  
 (2): AREA WAS DETERMINED BY THE COORDINATE METHOD AND ALL INFORMATION SHOWN ON THIS PLAT OUTSIDE THE SURVEYED PROPERTY LINES IS FOR DESCRIPTIVE INFORMATION ONLY.  
 (3): ALL REFERENCED MATERIALS ON THIS PLAT WERE USED TO PERFORM THIS SURVEY ONLY, THERE HAS NOT BEEN ANY TITLE SEARCH TO ACQUIRE THE INFORMATION SHOWN  
 (4): THERE HAS BEEN NO SURVEY DONE TO DETERMINE WETLANDS AND/OR UNSEEN STRUCTURES TO PROHIBIT DEVELOPEMENT OF THIS PROPERTY.

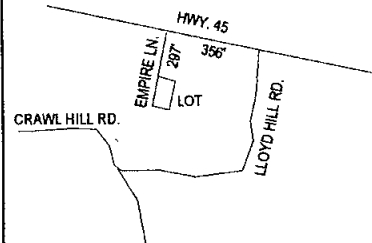

VICINITY MAP N.T.S.

TMS# 015-00-04-097  
 DEED REF.: BOOK 9327 @ PG. 125  
 PLAT REF.:

IRF: IRON ROD FOUND  
 IRS: IRON ROD SET  
 IPF: IRON PIPE FOUND  
 IPS: IRON PIPE SET  
 CMF: CONCRETE MONUMENT  
 Δ: CALCULATED POINT

Berkeley County Planning & Zoning  
 EXEMPT  
one new lot  
 (REASON)  
Williamham  
6/17/13 DATE

LAND ZONED "F-1"

Id	Bearing	Distance
L1	N 07°55'17" E	7.76'



EASEMENT AS SHOWN ON A  
 PLAT PREPARED BY: H. E.  
 METTS, RESORDED IN CAB.  
 N @ PG. 205-E; DATED: MAY 4, 1992  
 & UNRECORDED PLAT BY: H. E.  
 METTS SHOWING LOT "5"

00015321 P PAGE 356-5  
 PLAT CABINET  
 Filed and Recorded  
 Jun 17, 2013 03:24P  
 Cynthia B. Forte  
 Register of Deeds Berkeley Co. SC

LOT "2"  
 015-00-04-092  
 RITA LLOYD  
 BOOK 618 @ PG. 154

015-00-04-024  
 JACQUELYN BALLARD,  
 ET AL  
 BOOK 4642 @ PG. 337

1/2" IRF  
 S 75°08'57" E 124.03'  
 1/2" IRF  
 S 75°08'57" E 123.04'  
 1/2" IRF

N 05°17'24" E 192.31'  
 24'  
 66.30'  
 EX. M/H  
 66.30'  
 SEPTIC  
 LOT "5"  
 0.570-ACRES  
 24836.454-SQ. FT.  
 1/2" IRON  
 1/2" IRS  
 L1  
 127.85'  
 N 74°58'52" W  
 201.10'  
 S 04°20'16" W  
 1/2" IRF

LOT "4"  
 015-00-04-025  
 HEIRS OF JESSIE LLOYD  
 BOOK A-39 @ PG. 191

015-00-04-026  
 HEIRS OF GUY LLOYD

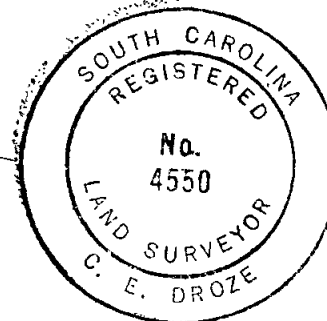

SURVEY CREATING TMS# 015-00-04-097  
 LABELED AS LOT "5"  
 OWNED BY: JAMES WELLS, JR.  
 1ST ST. STEPHEN PARISH - PINEVILLE  
 BERKELEY COUNTY, SOUTH CAROLINA

JUNE 12, 2013; REV.: 6-15-2013

C. E. DROZE  
 P.O. BOX 2132 MONCK'S CORNER, S.C. 29461  
 (843) 899-7597

SCALE 1" = 100'  
 0 50 100

I HEREBY STATE TO THE BEST OF MY KNOWLEDGE AND BELIEF THAT THE SURVEY SHOWN HEREON WAS MADE IN ACCORDANCE WITH THE REQUIREMENTS OF THE MINIMUM STANDARDS MANUAL FOR THE PRACTICE OF LAND SURVEYING IN SOUTH CAROLINA AND MEETS OR EXCEEDS THE REQUIREMENTS FOR A CLASS "B" SURVEY AS SPECIFIED THEREIN.

Cleatwood E. Droze  
 CLEATWOOD E. DROZE RLS# 4550