

VICINITY MAP N.T.S.

2018029425
BK: PLAT CABQ
PG: 394j
PRESENTED & RECORDED:
08-24-2018 04:30:14 PM
CYNTHIA B FORTE
REGISTER OF DEEDS
BERKELEY COUNTY, SC

Berkeley County Planning & Zoning
Received As Information

Paul
8/24/18 Admin Officer
Date

RESERVED FOR SIGNING

NOTES:

1. THIS IS TO CERTIFY THAT I HAVE CONSULTED THE FEDERAL INSURANCE ADMINISTRATION FLOOD HAZARD BOUNDARY MAP, AND FIND THE SURVEY DESCRIBED IS NOT LOCATED IN A SPECIAL FLOOD HAZARD AREA.
SEE FIRM PANEL 45015C 0275 D, EFFECTIVE 10/16/2003
2. AREA WAS DETERMINED BY THE COORDINATE METHOD AND ALL INFORMATION SHOWN ON THIS PLAT OUTSIDE THE SURVEYED PROPERTY LINES IS FOR DESCRIPTIVE INFORMATION ONLY.
3. ALL REFERENCED MATERIALS ON THIS PLAT WERE USED TO PERFORM THIS SURVEY ONLY, THERE HAS NOT BEEN ANY TITLE SEARCH TO ACQUIRE THE INFORMATION SHOWN.
4. THERE HAS BEEN NO SURVEY DONE TO DETERMINE WETLANDS AND/OR UNSEEN STRUCTURES TO PROHIBIT DEVELOPMENT OF THIS PROPERTY.
5. THIS PROPERTY IS ZONED: FLEX-1
6. LOT IS SERVICED BY BERKELEY COUNT WATER & SEWER

LEGEND
IRF IRON ROD FOUND
IPF IRON PIPE FOUND
IRS IRON ROD SET

REFERENCES:

- 1) PLAT RECORDED IN PLAT CABINET E, PAGE 327.

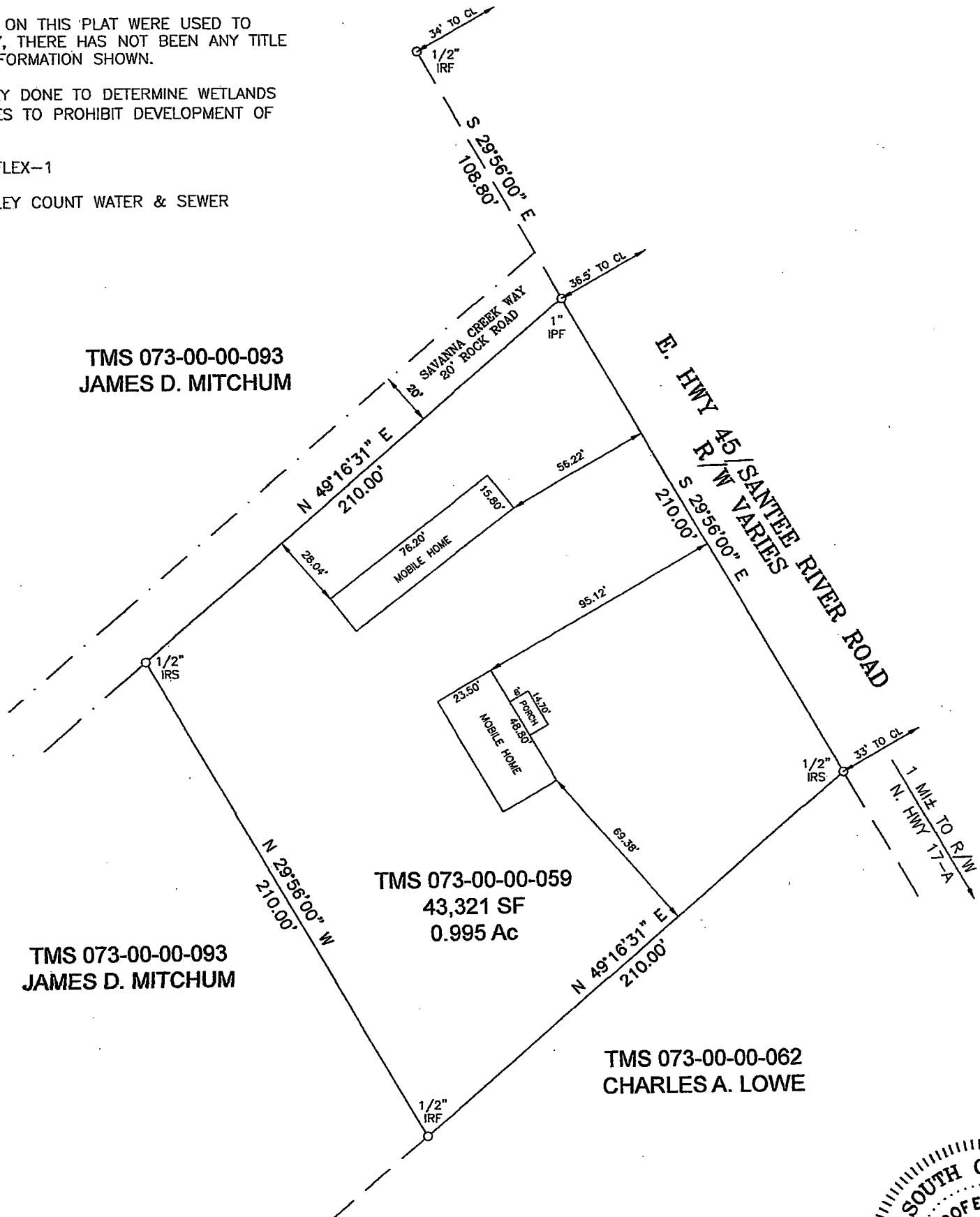

TMS 073-00-00-093
JAMES D. MITCHUM

TMS 073-00-00-093
JAMES D. MITCHUM

TMS 073-00-00-059
43,321 SF
0.995 Ac

TMS 073-00-00-062
CHARLES A. LOWE

BOUNDARY SURVEY OF
TMS 073-00-00-059, OWNED BY
BERNIE JEAN FLOYD, ETAL
2ND ST. STEPHEN PARISH
BERKELEY COUNTY, SOUTH CAROLINA
AUGUST 14, 2018

ANDREW B. WADSWORTH, SR. R.L.S.
2009 VESTRY DRIVE
CHARLESTON, S.C. 29414
(843) 709-3423
andrew.wadsworthsr@gmail.com
JOB# 2018-026

SCALE : 1" = 50'
0' 50' 100'



I HEREBY STATE TO THE BEST OF MY KNOWLEDGE, INFORMATION AND BELIEF, THE SURVEY SHOWN HEREON WAS MADE IN ACCORDANCE WITH THE REQUIREMENTS OF THE MINIMUM STANDARDS MANUAL FOR THE PRACTICE OF LAND SURVEYING IN SOUTH CAROLINA, AND MEETS OR EXCEEDS THE REQUIREMENTS FOR A CLASS "C" SURVEY AS SPECIFIED THEREIN.

Andrew B. Wadsworth, Sr.
ANDREW B. WADSWORTH, SR. RLS# 16141