

NOTE: THIS IS TO CERTIFY THAT I HAVE CONSULTED THE FEDERAL INSURANCE ADMINISTRATION FLOOD HAZARD BOUNDARY MAP, AND FIND THE SURVEY DESCRIBED IS NOT LOCATED IN A SPECIAL FLOOD HAZARD AREA.

LAND ZONED "F-1"

LOT "1" - TMS# 110-00-02-094
DEED REF.: BOOK 1204 @ PG. 280

LOT "2" - TMS# 110-00-02-041
DEED REF.: BOOK A-49 @ PG. 133

NOTE: LAND SERVED BY PUBLIC WATER.

Id	Bearing	Distance
L1	S 32°00'00" E	15.00'

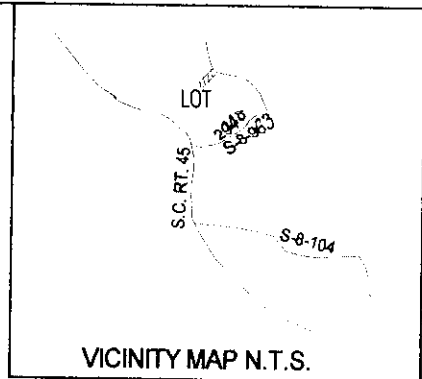

IRF: IRON ROD FOUND
IRS: IRON ROD SET
IPF: IRON PIPE FOUND
IPS: IRON PIPE SET
CMF: CONCRETE MONUMENT
O.I.: OLD IRON

Doc# 0021152
PLAT CABINET 0 PAGE 302 D
Filed and Recorded
10/18/2000 11:43:56AM
Cynthia B. Forte
Register of Deeds Berkeley Co.
SC

Berkeley County Planning Commission

Exempt

[Signature]
(Reason)
[Signature]
10-18-00 Date

110-00-02-041
HEIRS OF ISAAC
NOLE

LOT "2"
0.082-ACRES
3553.974-SQ. FT.

LOT "1"
0.986-ACRES
42971.119-SQ. FT.

110-00-02-045
ALBERT NOLE

110-00-02-043
ALLIE RAMSEY

BOUNDARY SURVEY OF LOT "1", 0.986-AC.
SHOWING ADDITION OF LOT "2", 0.082-AC.
LOT "1" - OWNED BY: YONDA MORRISON
LOT "2" - OWNED BY: HEIRS OF ISAAC NOLE
LOT "2" - BEING CONVEYED TO:
YONDA MORRISON
ST. JAMES - SANTEE PARISH
BERKELEY COUNTY, SOUTH CAROLINA

OCTOBER 5, 2000

ROBERT J. SAMPLE, P. E., R.L.S.
P.O. BOX 31263 CHARLESTON, S.C. 29407
(843) 766- 8224

SCALE 1" = 100'
0 50 100

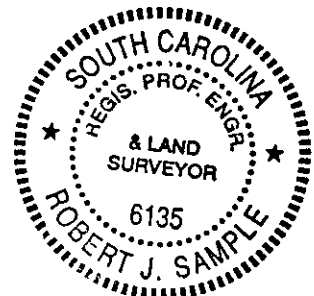

I HEREBY STATE TO THE BEST OF MY KNOWLEDGE AND BELIEF THAT THE SURVEY SHOWN HEREON WAS MADE IN ACCORDANCE WITH THE REQUIREMENTS OF THE MINIMUM STANDARDS MANUAL FOR THE PRACTICE OF LAND SURVEYING IN SOUTH CAROLINA AND MEETS OR EXCEEDS THE REQUIREMENTS FOR A CLASS "A" SURVEY AS SPECIFIED THEREIN.

ROBERT J. SAMPLE RLS# 6135